

DROP DOOR SKIPS

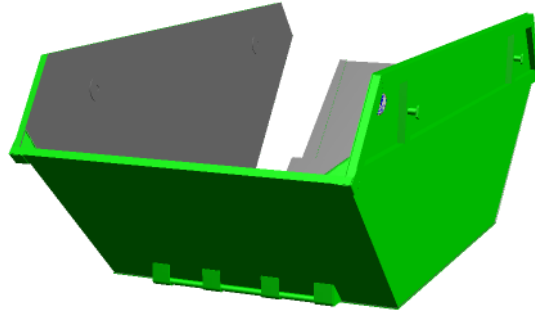

Product Specifications

Application: General / Commercial / Industrial / Construction



8 CUYD Drop Door Skip pictured

Details: All Drop Door Skips

- **Steel** - All prime grade mild steel (HR15 or S275)
- **Door Details** – Secure Lift up and open 3mm mild steel door reinforced with RSC 76 x 38mm Door pivots on RSC76mm x 38mm and is fitted with secondary locking facility so door cannot be opened by mistake
- **Door Pivoting** - Rnd25mm welded to door pivots on PFC76mm x 38mm – giving secure and unhampered movement of door
- **Gusseting** - Substantial 3mm mild steel gusseting all around each side and below door opening
- **Extra Reinforcing** – Rail of PFC 76mm x 38mm reinforcement welded on inside of skip below door

Size	Drawing No	Length	Width	Height
2 CUYD (flat top) 1.53 CUM	OS/048	6' 1830mm	4'1" 1250mm	3' 915mm
3 CUYD 2.30 CUM	OS/033	7' 3" 2208mm	5'4" 1250mm	2' 8 1/2 " 828mm
4 CUYD 3.06 CUM	OS/003	8' 3" 2514mm	5'4" 1625mm	3' 3 1/2" 1000mm
5 CUYD 3.83 CUM	OS/045	9' 9" 2996mm	5'4" 1625mm	3' 3 1/2" 1000mm
6 CUYD 4.60 CUM	OS/004, OS/004HD, OS/004CH, OS/004CHLW	10' 11" 3302mm	5'4" 1625mm	3' 3 1/2" 1000mm
6 CUYD 4.60 CUM	OS/006 & OS/ 006LW	10' 3050mm	5' 6" 1676mm	3' 7 " 1092mm
7 CUYD 5.35 CUM	OS/007 & OS/ 007LW	10' 8" 3264mm	5' 6" 1676mm	3' 10 1/2" 1220mm
8 CUYD 6.12 CUM	OS/008 & OS/ 008LW	11' 2" 3404mm	5' 6" 1676mm	4' 1 1/4" 1250mm